



Etching unit in plastic case

Metal etching unit

10-30-3 / Timer

TECHNICAL SPECIFICATIONS

Power output:	Mains supply:	Output:
30 VA	220 V~ - 50/60 Hz	12 V~ / AC
		12 V = / DC with module (accessory)

SCOPE OF SUPPLY FOR THE MARKING SET

- A** Marking stamp (1x)
- B** Stencils for customer's own designs (100 sheets)
- D** Contact plate (1x)
- E** Electrolyte container (1x)
- F** Etching unit (1x)
- G** Cable for etching stamp (1x)
- H** Bottle of electrolyte (1x)
- I** Bottle of Neutralin (1x)
- K** Cable for contact plate (1x)
- L** With crocodile clip

WORK PROCEDURE

1. Inscribe stencil **B** using a typewriter (but without the ribbon), ball-point pen or sharply pointed, hard pencil. Alternatively, you can use a stencil tape for the Brother P-touch or CASIO Label Printer. Long-run stencils can be made up for you to your specifications, for example with your company logo.
2. Connect cable **G** to etching stamp **A**. Connect cable **K** to contact plate **D** using crocodile clip **L**.
3. Moisten the felt and conductive fabric on etching stamp **A** with electrolyte **H**.
4. Connect etching unit **F** to a 220 V~ / 50/60 Hz mains supply.
5. Place workpiece **C** on contact plate **D**.
6. Place stencil **B** on workpiece **C**.
- 7a. If you are using the timer, set switch **M** to "Timer" and set the required etch time, e.g. 3 sec. Now apply etching stamp **A** to stencil **B** until the acoustic signal indicates that the etch time has expired.
- 7b. If you are not using the timer, set switch **M** to "Manual" and apply etching stamp **A** to stencil **B** or, if the marking is larger, slide the stamp across the stencil several times until the required degree of marking has been achieved.
8. After completing the etching operation, place the etching stamp **A** in electrolyte container **E**.
9. If necessary, re-moisten the marking felt and conductive fabric with clean electrolyte **H**. The marking felt and conductive fabric must always be adequately moistened with electrolyte **H**.
10. To ensure optimum etching results, we recommend cleaning the stencil **B** occasionally under running water when residues have built up on it.
11. After completing the etching operation, wipe off the workpiece **C** with NEUTRALIN **I**.
12. The unit is fitted with an overload warning device that indicates an overload with a light-emitting diode.
13. When you have finished work, switch off the unit.

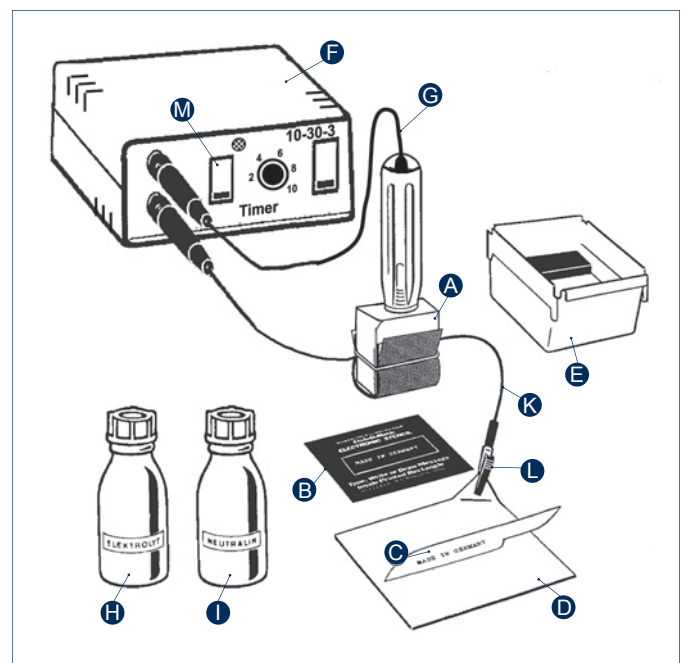

IMPORTANT:

AFTER THE MARKING OPERATION, PLACE THE ETCHING STAMP (A) IN THE ELECTROLYTE CONTAINER (E) AND NOT ON THE CONTACT PLATE (D).

WHERE WORK INTERRUPTIONS ARE LIKELY TO BE 12 HOURS OR MORE, STORE THE ELECTROLYTE CARRIER IN AN AIRTIGHT CONTAINER.